

- 📱 O primeiro passo é abrir o aplicativo móvel DISH e fazer login. Clique em **entrar** para prosseguir.

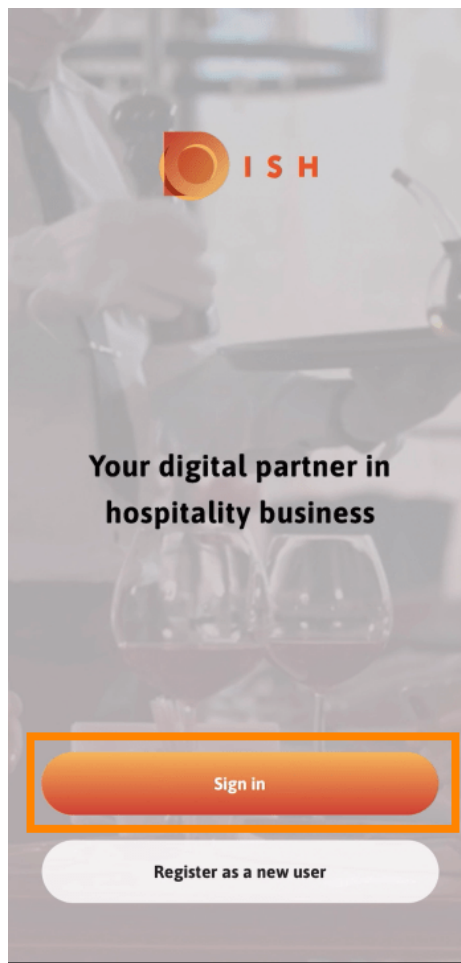

- 1 Clique em **continuar** para ser redirecionado para a página de login único do DISH.

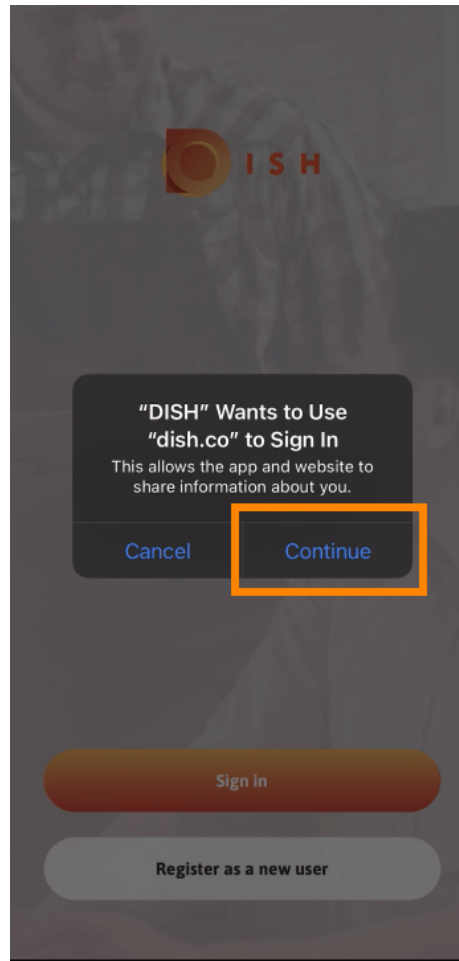

 Digite o **nome de usuário** e a **senha** .

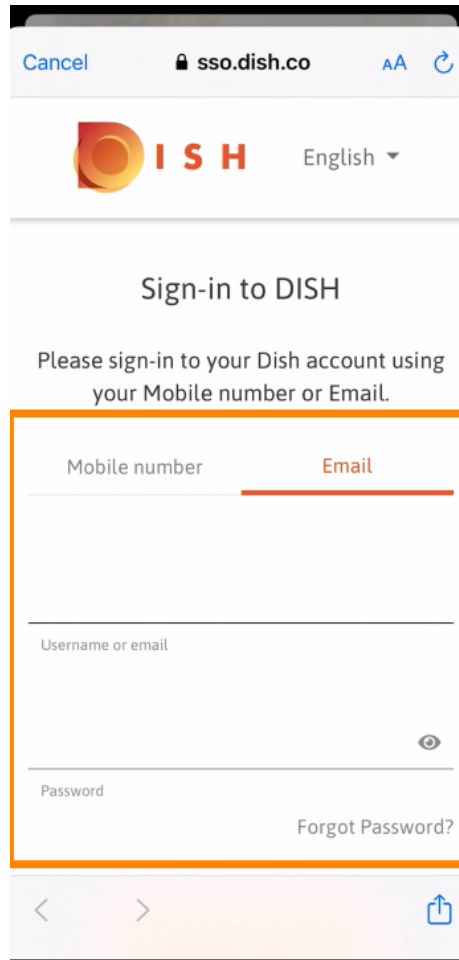

The screenshot shows the mobile sign-in page for DISH. At the top, there is a browser address bar with "Cancel", a lock icon, "sso.dish.co", and "AA" and refresh icons. Below the address bar is the DISH logo and a language dropdown menu set to "English". The main heading is "Sign-in to DISH". Below this, a message reads: "Please sign-in to your Dish account using your Mobile number or Email." There are two tabs: "Mobile number" and "Email", with "Email" being the active tab. Below the tabs is a text input field labeled "Username or email". Below that is a password input field labeled "Password" with an eye icon for toggling visibility. A "Forgot Password?" link is located to the right of the password field. The bottom of the screen shows standard mobile navigation icons: back, forward, and share.



Conclua esta etapa clicando em **log in** .

Cancel sso.dish.co AA X

Please sign-in to your Dish account using your Mobile number or Email.

Mobile number **Email**

training@hd.digital

Username or email

●●●●●●●●●●

Password [Forgot Password?](#)

Log In

No Account yet?
[Sign up](#)

- 📱 A ferramenta **DISH Reservation** será exibida em suas ferramentas. Clique nela para abrir seu painel.

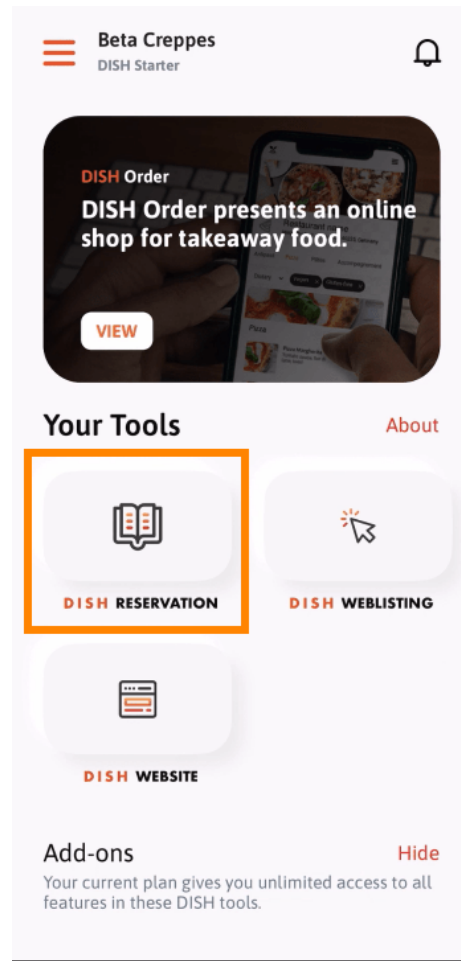

Continue clicando em **Reserva de DISH**.

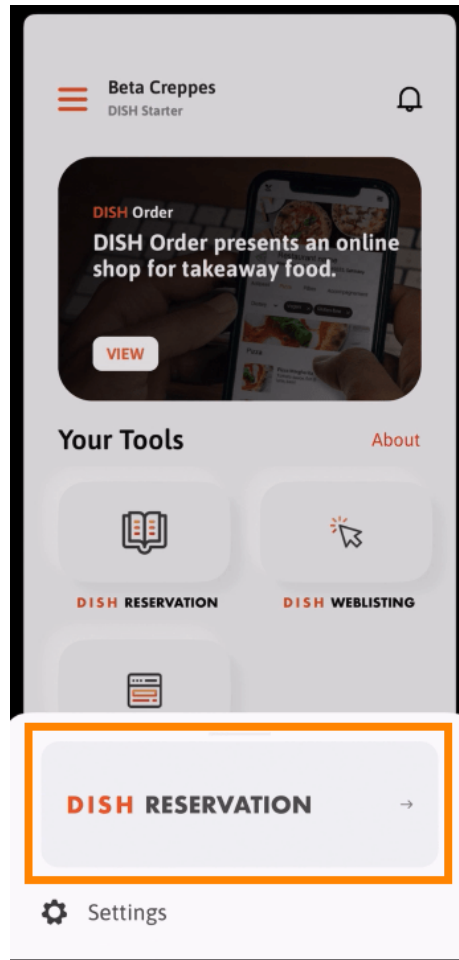

Para garantir altos padrões de qualidade, concorde com o **uso de cookies** .

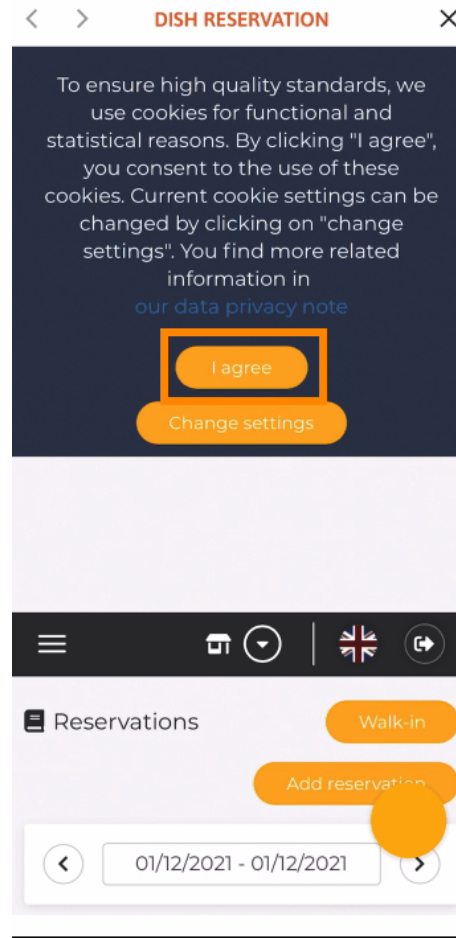

 Pronto. Agora você está na versão mobile do DISH Reservation.

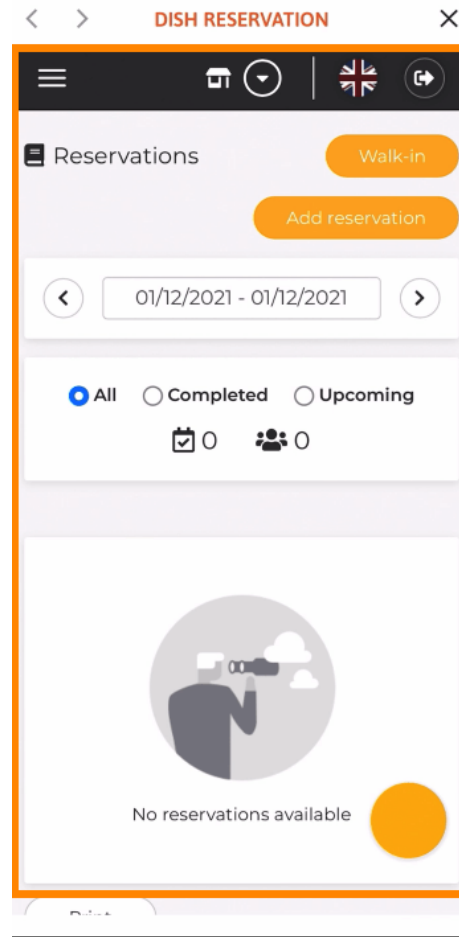



Digitalize para ir para o player interativo