



Miután bejelentkezett a Facebook-oldalára, kattintson **a hozzáadása gombra** .

The screenshot displays the Facebook page management interface for 'DISH Support Restaurant'. The page is viewed from the perspective of the page administrator. The top navigation bar includes a search bar, home, friends, and groups icons, and a 'Find Friends' button. The left sidebar contains a 'Manage Page' section with various tools like Home, News Feed, Inbox, Business Apps, Resources & Tools, Notifications, Insights, Publishing Tools, Ad Center, Page Quality, and Edit Page Info. The main content area shows the restaurant's profile with a cover photo, a profile picture, and a blue '+ Add a Button' button highlighted with an orange box. Below the button are several sections: 'Post job openings for DISH Support Restaurant' with a 'Post Job' button, 'Set Your Page up for Success' with a progress bar showing 5 of 14 steps completed, and 'Create Post' with options for Photo/Video, Get Messages, and Feeling/Activity. At the bottom, there are buttons for 'Create', 'Live', 'Event', 'Offer', and 'Ad'.



Megnyílik egy felugró ablak, amely különböző lehetőségeket kínál. Ezután válassza ki az **indítási sorrendet**.

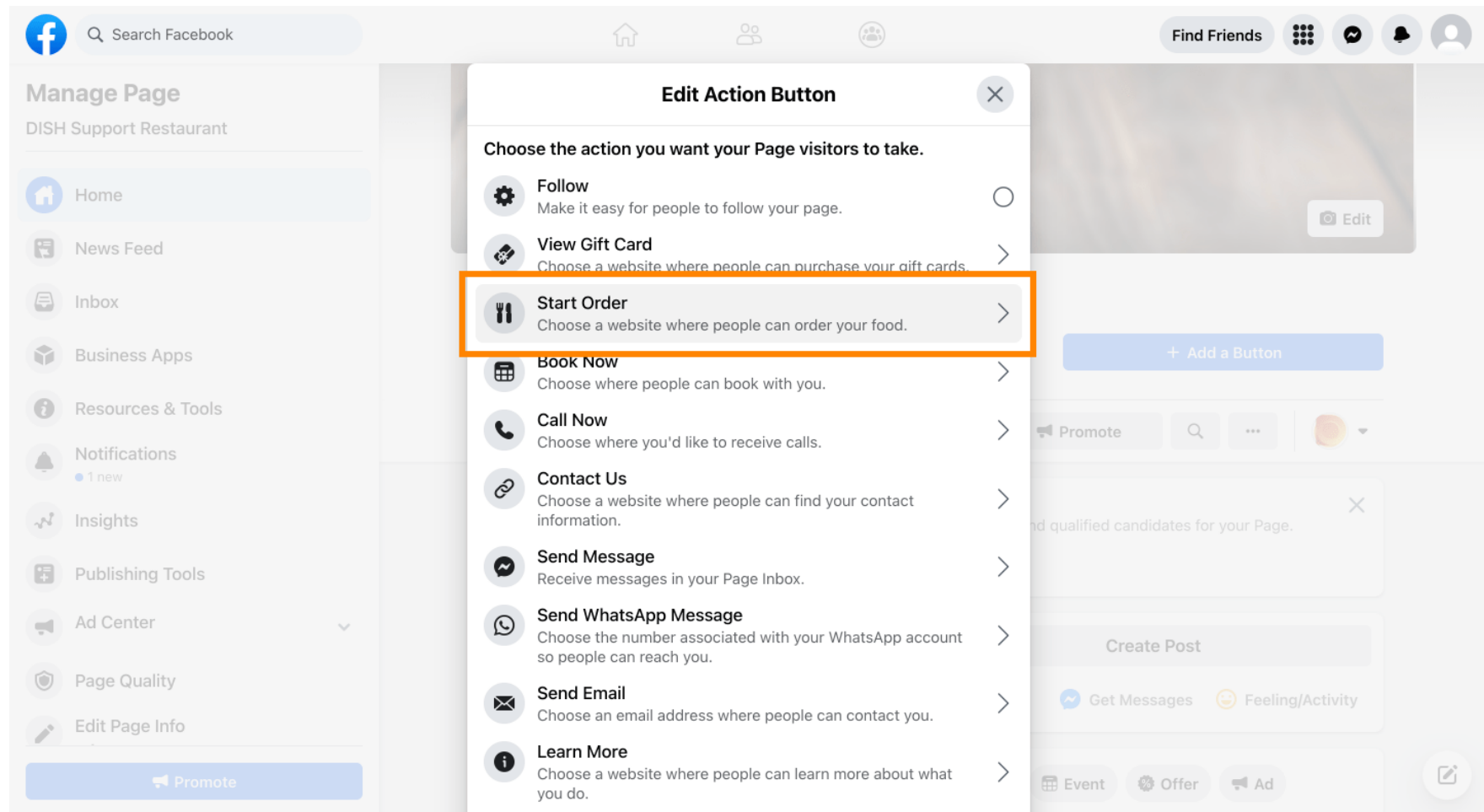



Most adja meg az Ételrendelés menü **URL-címét** .

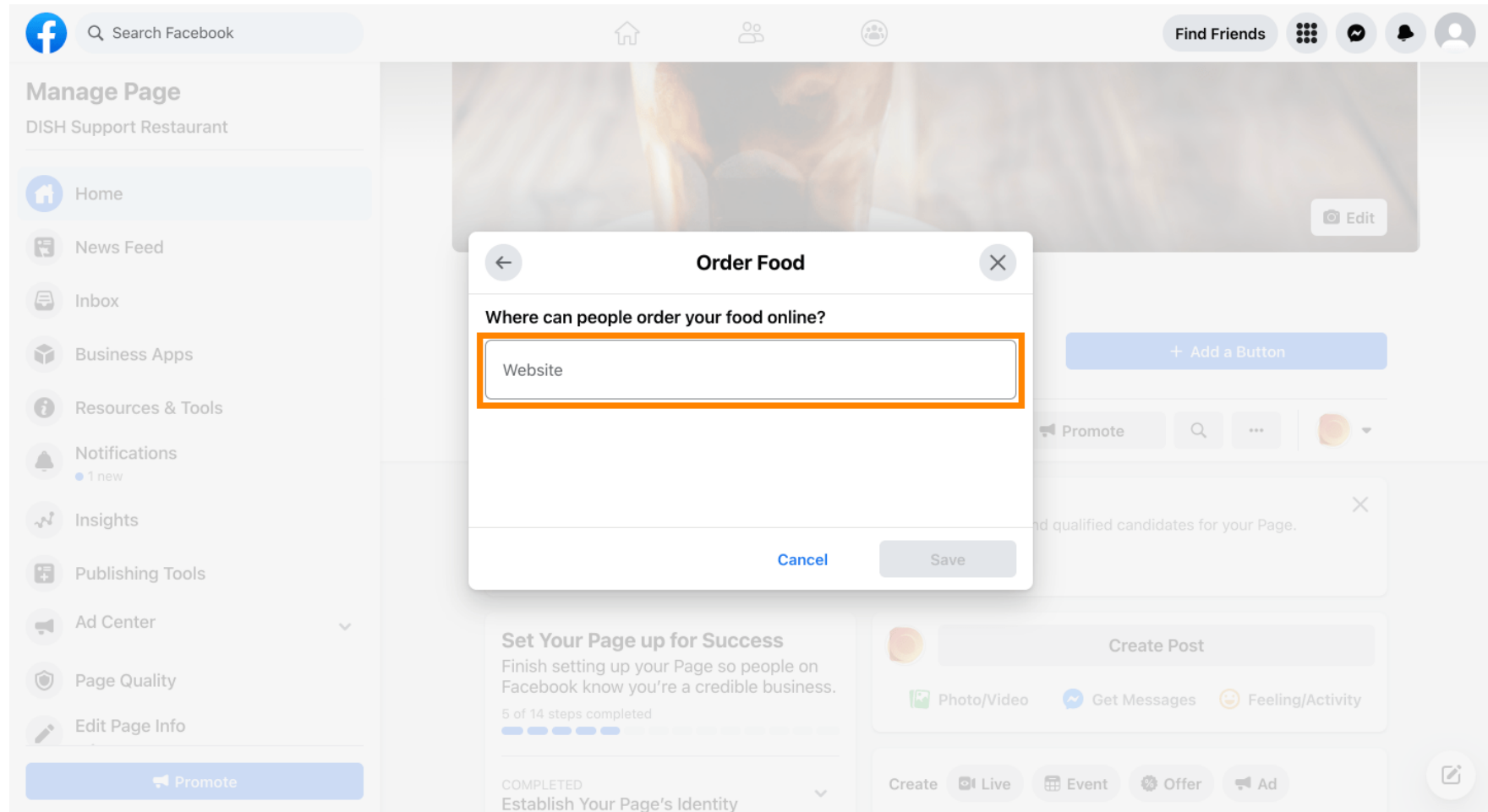



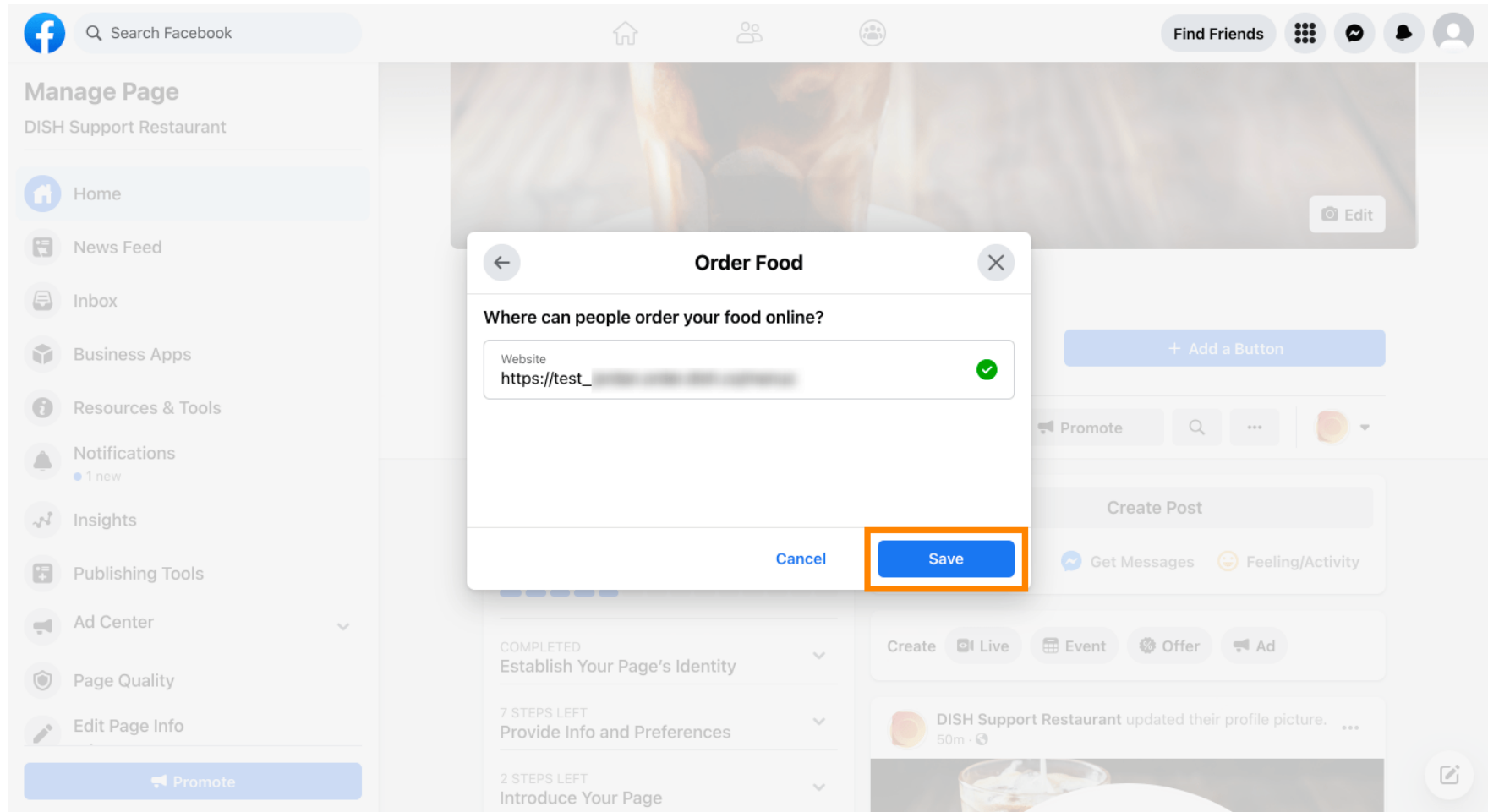

És a folytatáshoz kattintson a **Mentés gombra**.

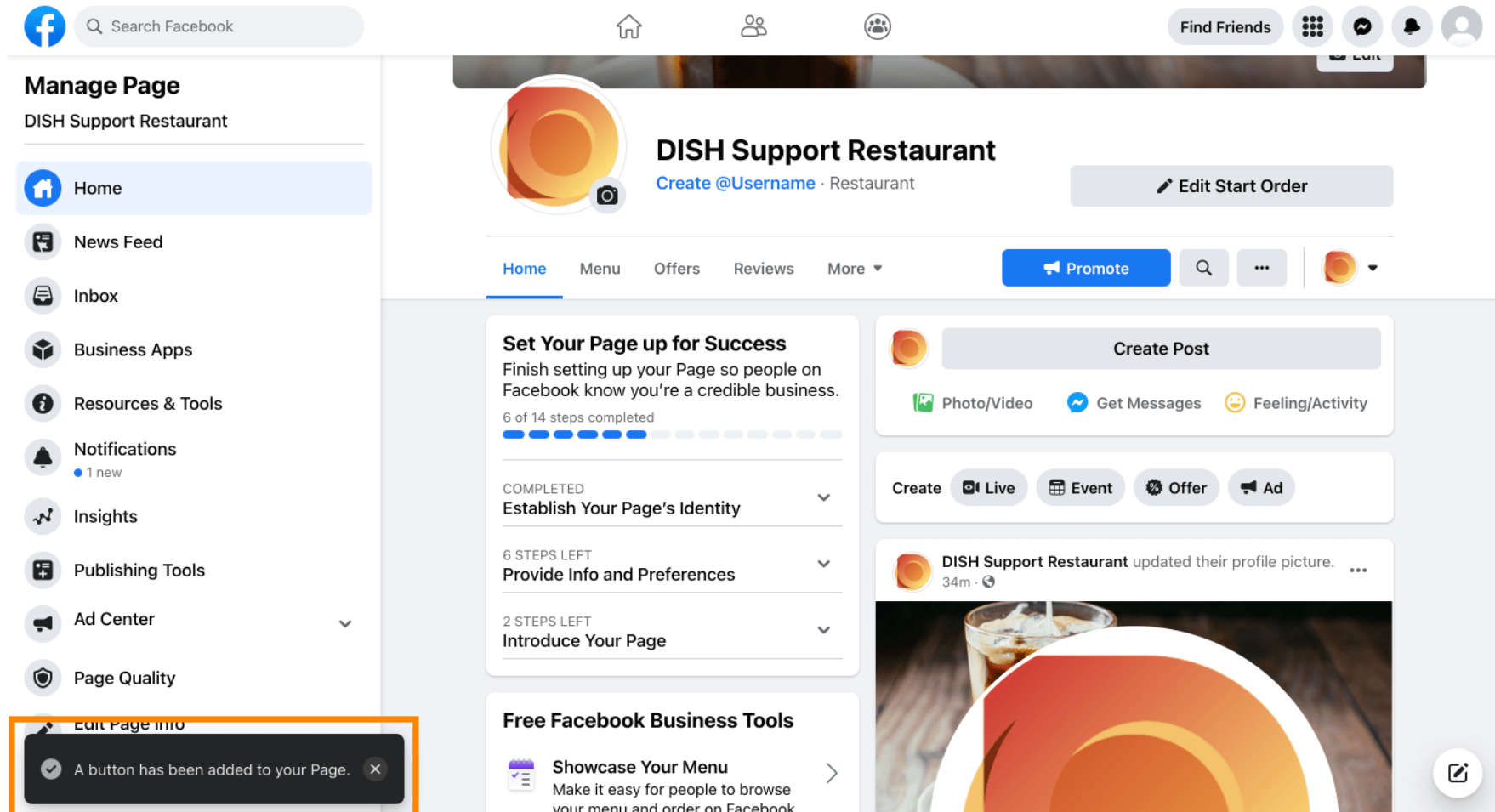

 A bal alsó sarokban lévő kis **felugró ablak jelzi, hogy a gomb sikeresen hozzáadásra került.**



 Így fog kinézni a vendégek számára.

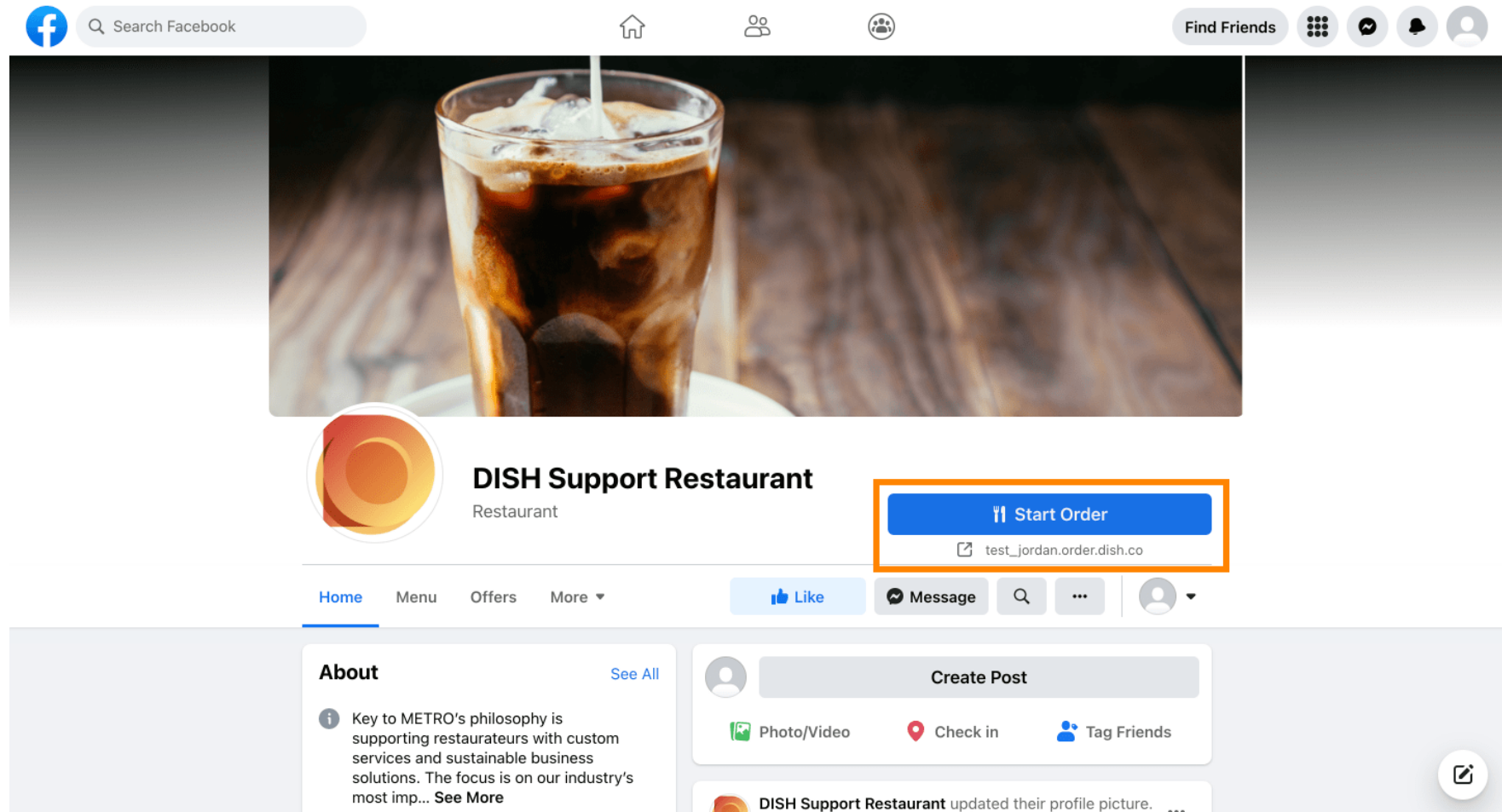



Szkennelés az interaktív lejátszó megnyitásához