

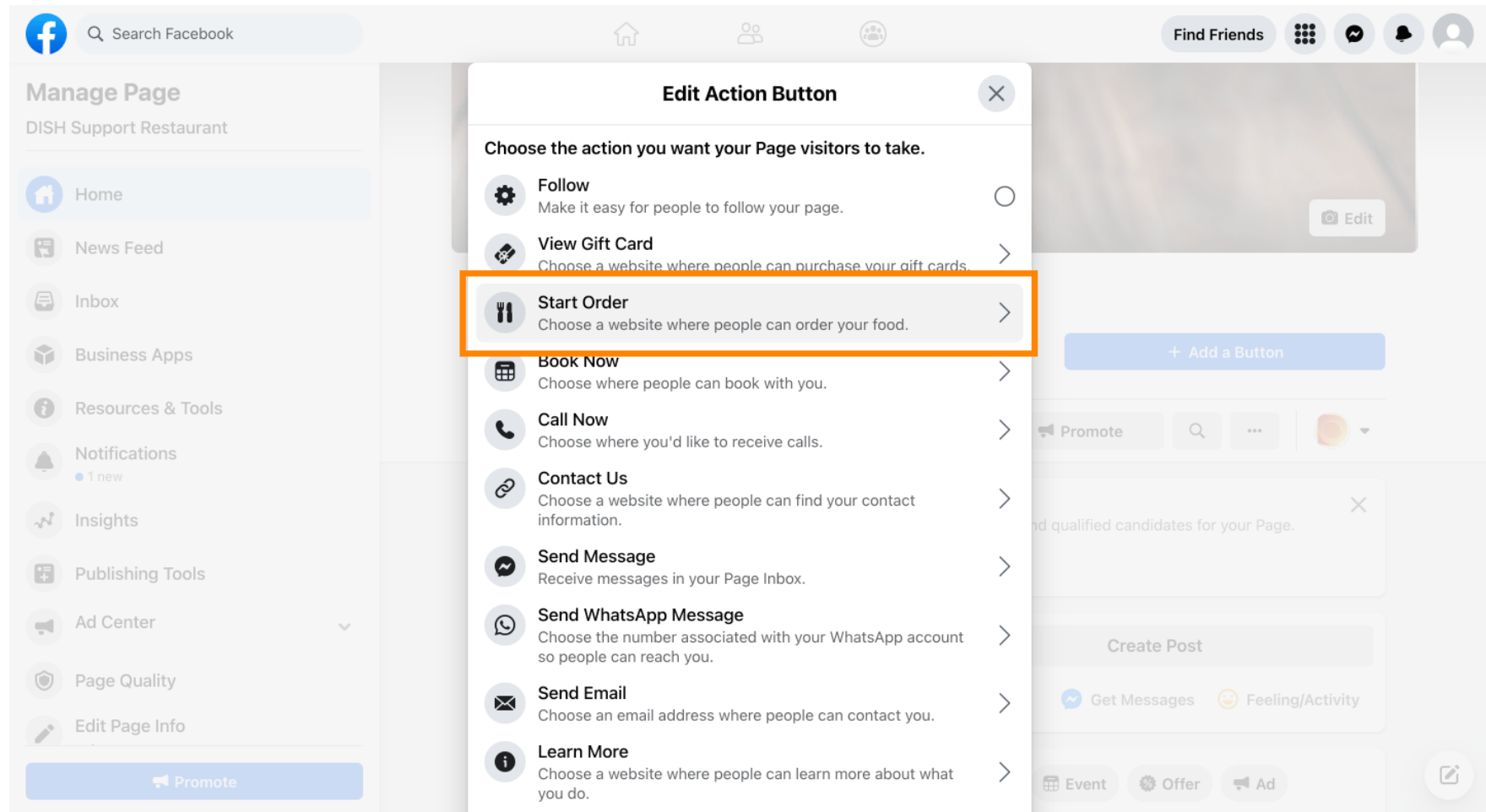

Una volta effettuato l'accesso alla tua pagina Facebook, clicca su **Aggiungi un pulsante**.

The screenshot displays the Facebook page management interface for 'DISH Support Restaurant'. The left sidebar contains a 'Manage Page' section with various tools like Home, News Feed, and Business Apps. The main content area features a cover photo, a profile picture, and a blue button labeled '+ Add a Button' which is highlighted with an orange border. Below this, there are several promotional and utility sections, including a job opening post, a 'Set Your Page up for Success' progress indicator, and a 'Create Post' section with options for Photo/Video, Get Messages, and Feeling/Activity.

Si aprirà un pop-up con diverse opzioni. Quindi seleziona **avvia ordine**.



T Ora inserisci l'URL del tuo menu DISH Order .

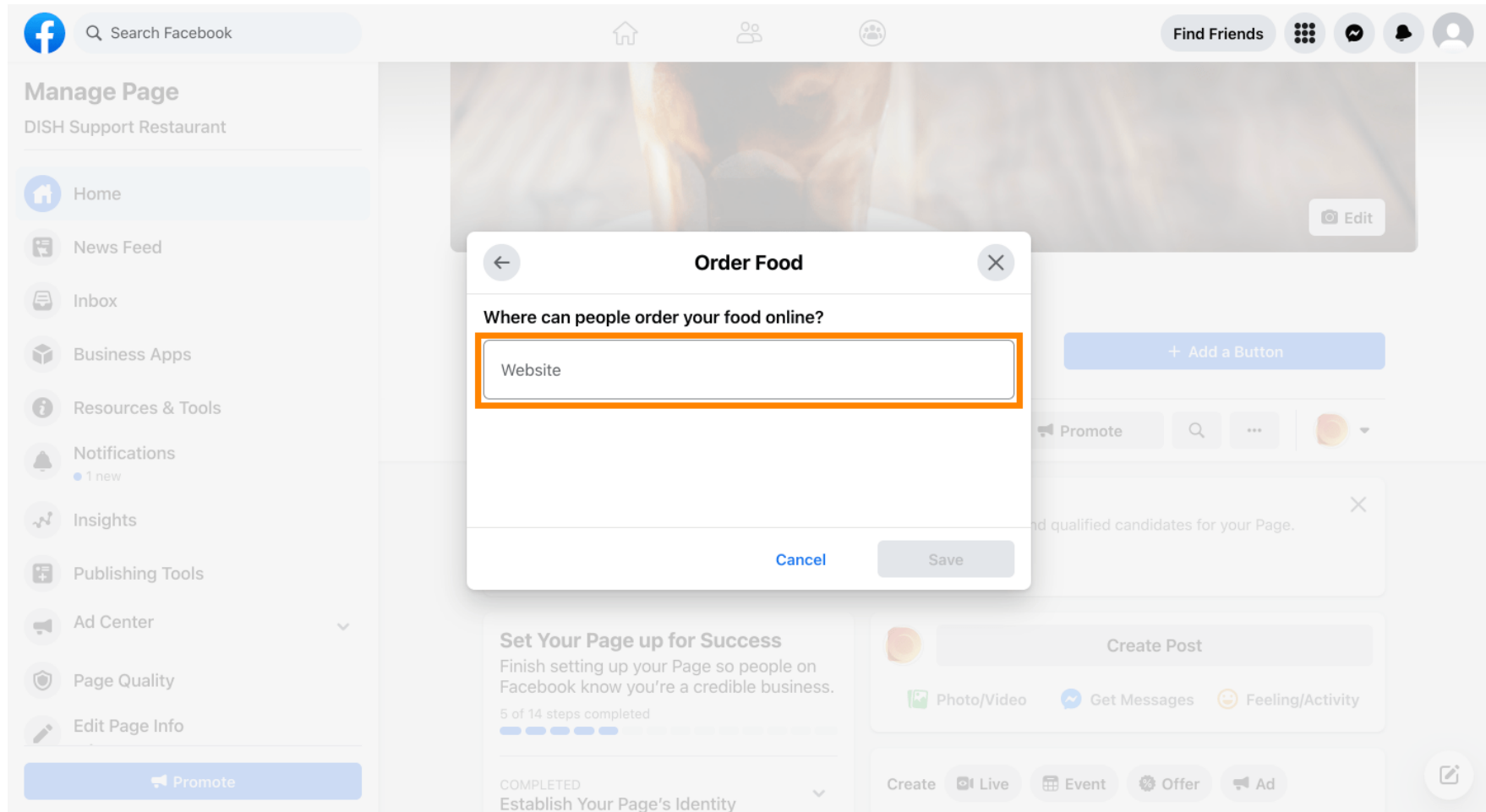



E clicca su **Salva** per procedere.

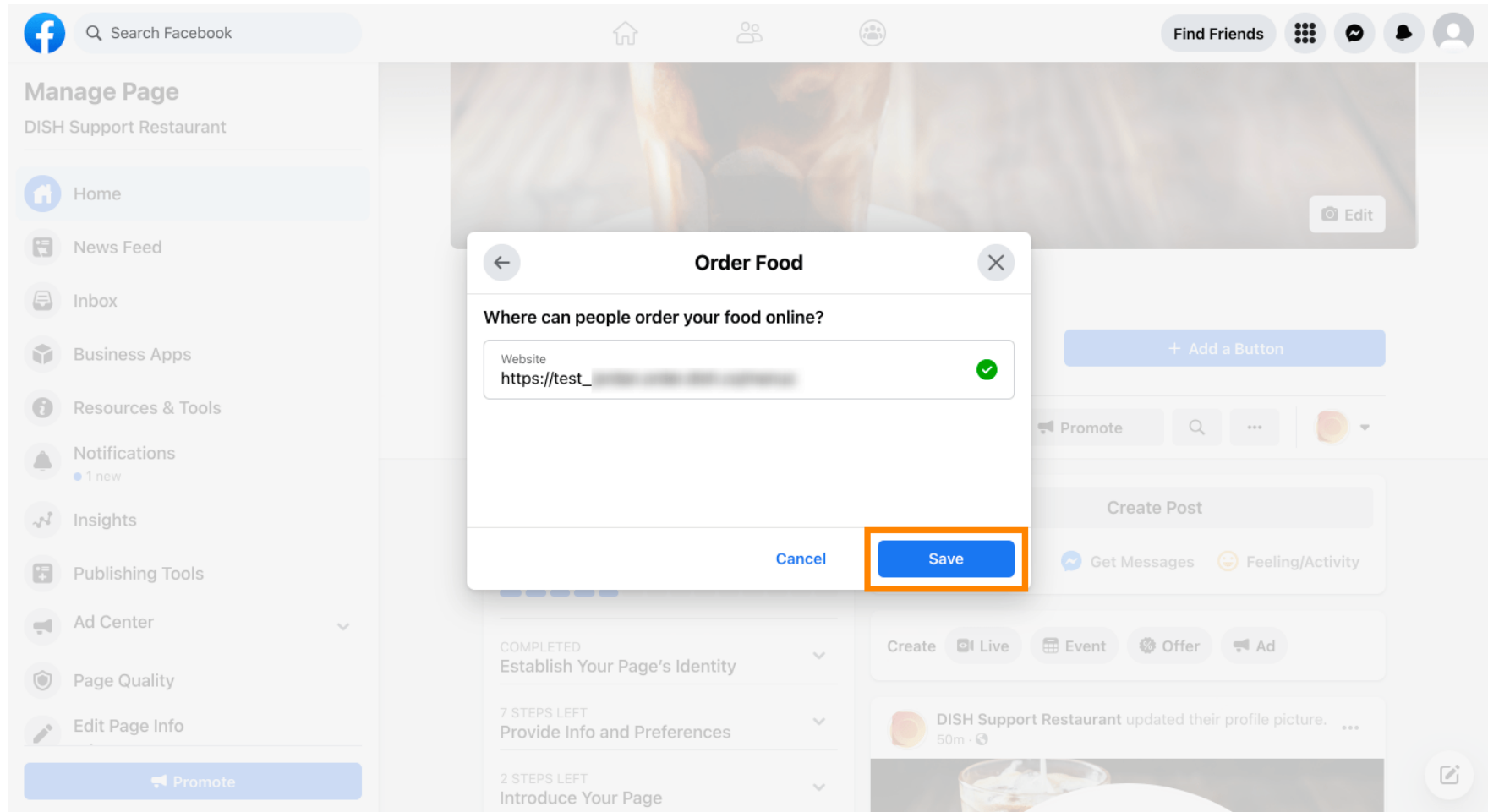



Il piccolo **pop-up** nell'angolo in basso a sinistra indica che il pulsante è stato aggiunto correttamente.

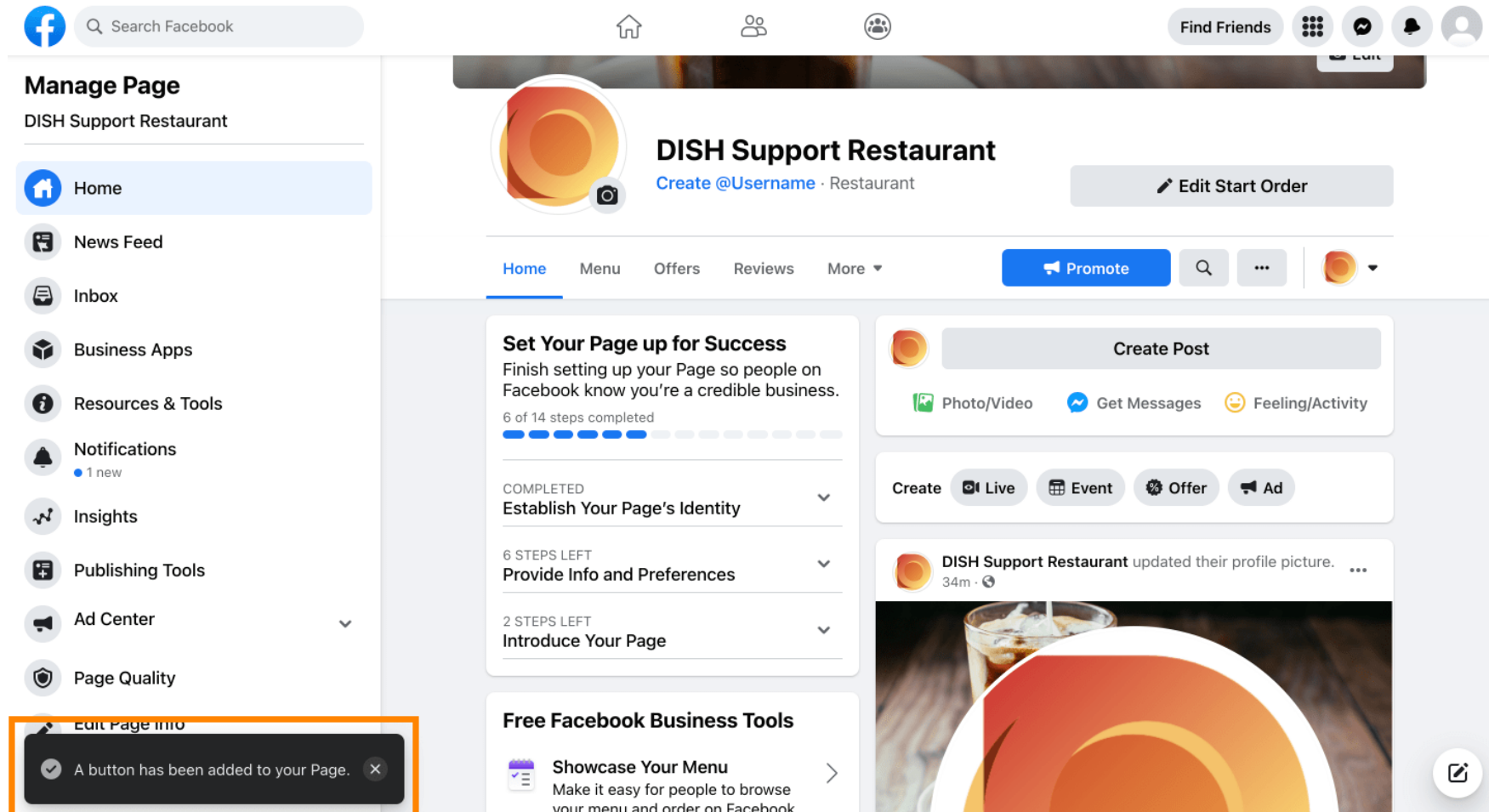

 Ecco come apparirà ai tuoi ospiti.

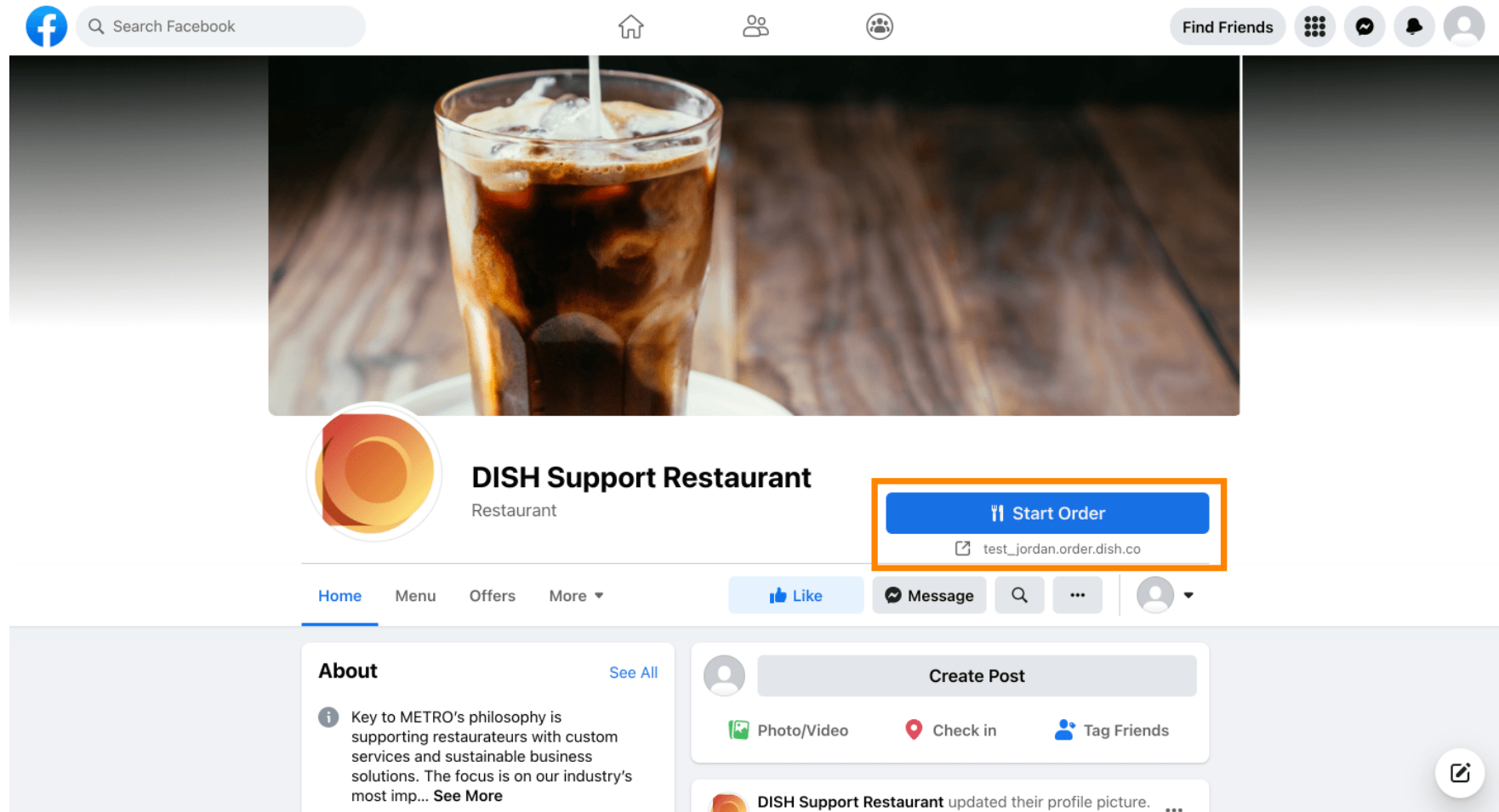



Scansiona per andare al lettore interattivo