

 Il primo passo è accedere al tuo **Google Business Profile Manager**.

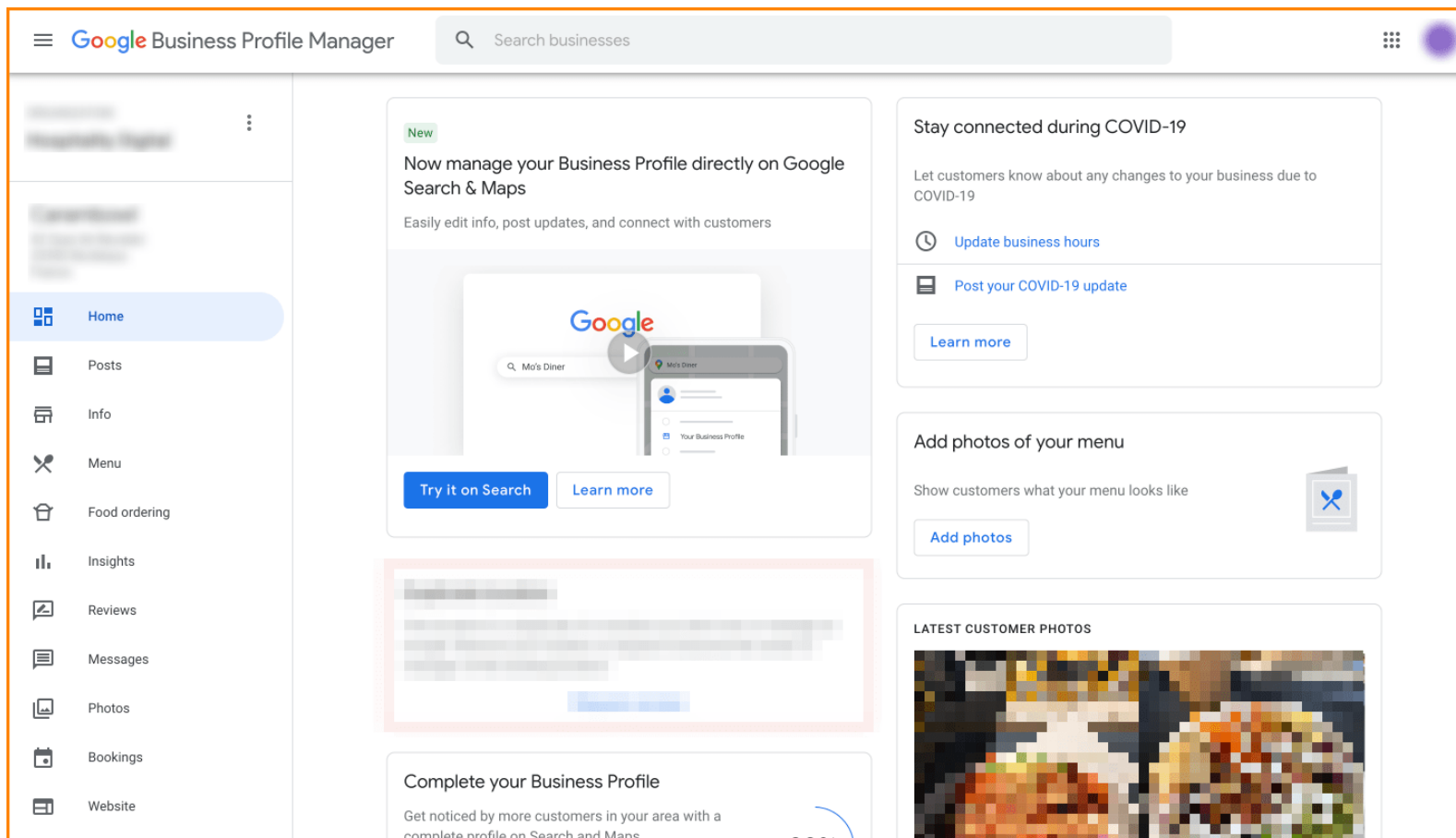

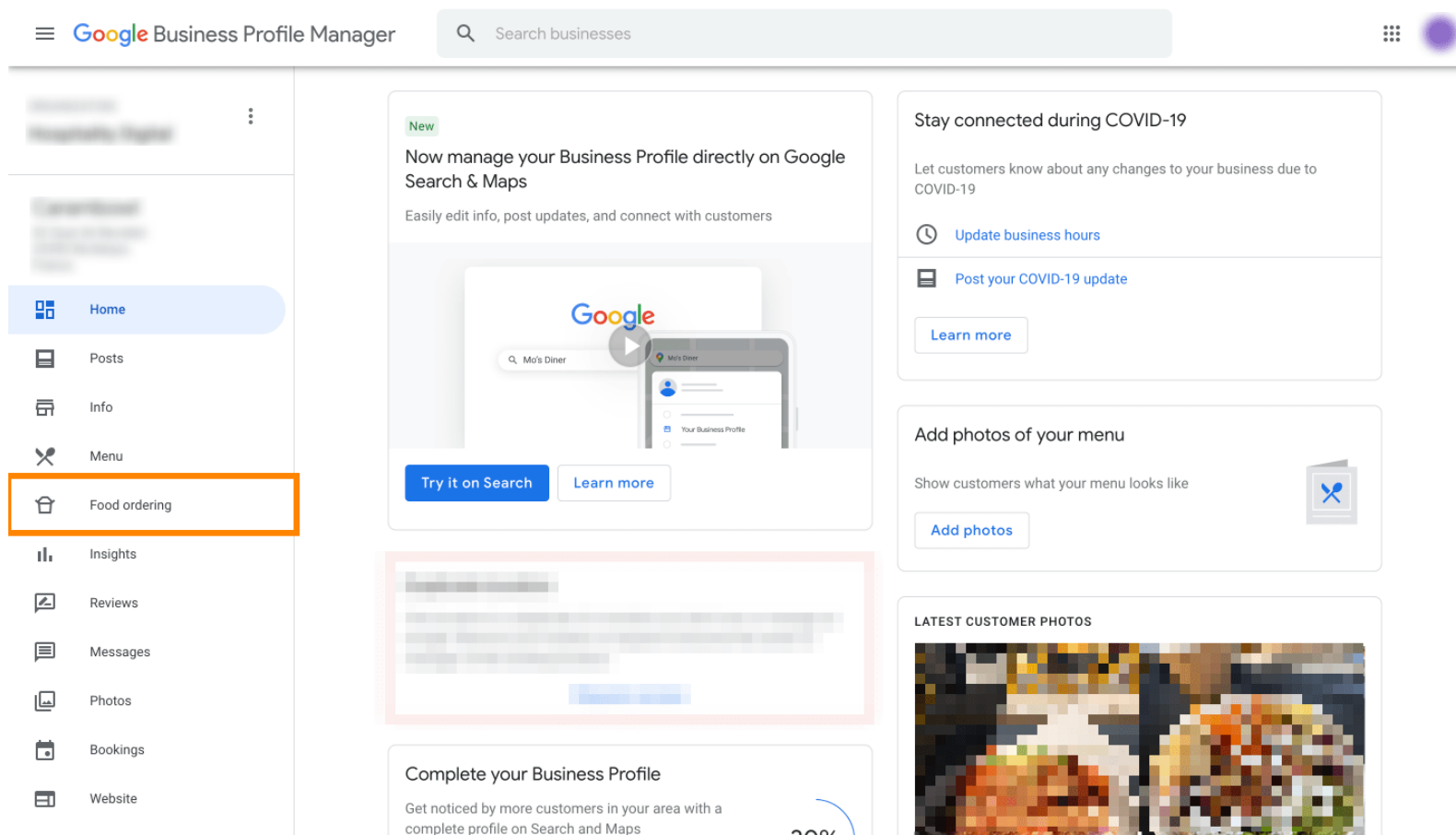

Clicca su **Ordinazione cibo**.





Qui puoi gestire gli ordini di cibo online su Google. Seleziona "orderdirect" per il ritiro e la consegna .

Google Business Profile Manager

Search businesses

Home

Posts

Info

Menu

Food ordering

Insights

Reviews

Messages

Photos

Bookings

Website

Users

Create an ad

Businesses

Settings

Support

Manage online food ordering on Google

Manage how customers place online food orders from your Business Profile on Google Search and Maps

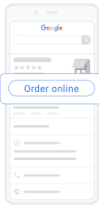



Your "Order online" button

Button is on

Select your preferred Order with Google providers

Select your preferred provider for pickup or delivery. Your preferences will be labeled on your profile. [Learn more](#)

Provider	Clear selection	Pickup	Delivery
 orderdirect		<input checked="" type="radio"/>	<input checked="" type="radio"/>
 Lieferando.de		<input type="radio"/>	<input type="radio"/>

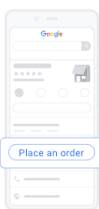

Manage your "Place an order" link

View and manage custom menu links that let customers place orders through other online ordering pages or apps. [Learn more](#)

Ordering link*

<https://metro.bar/#orde>

Select service options offered at this link *

Offers pickup ☒ Offers delivery ☒

[Add new link](#)

©2022 Google - Terms - Privacy Policy - Content Policy - Help

3 di 9



Sotto **Gestisci il link "Effettua ordine"** puoi aggiungere l' **URL** del tuo negozio online e selezionare le **opzioni di servizio** offerte dal link cliccandoci sopra.

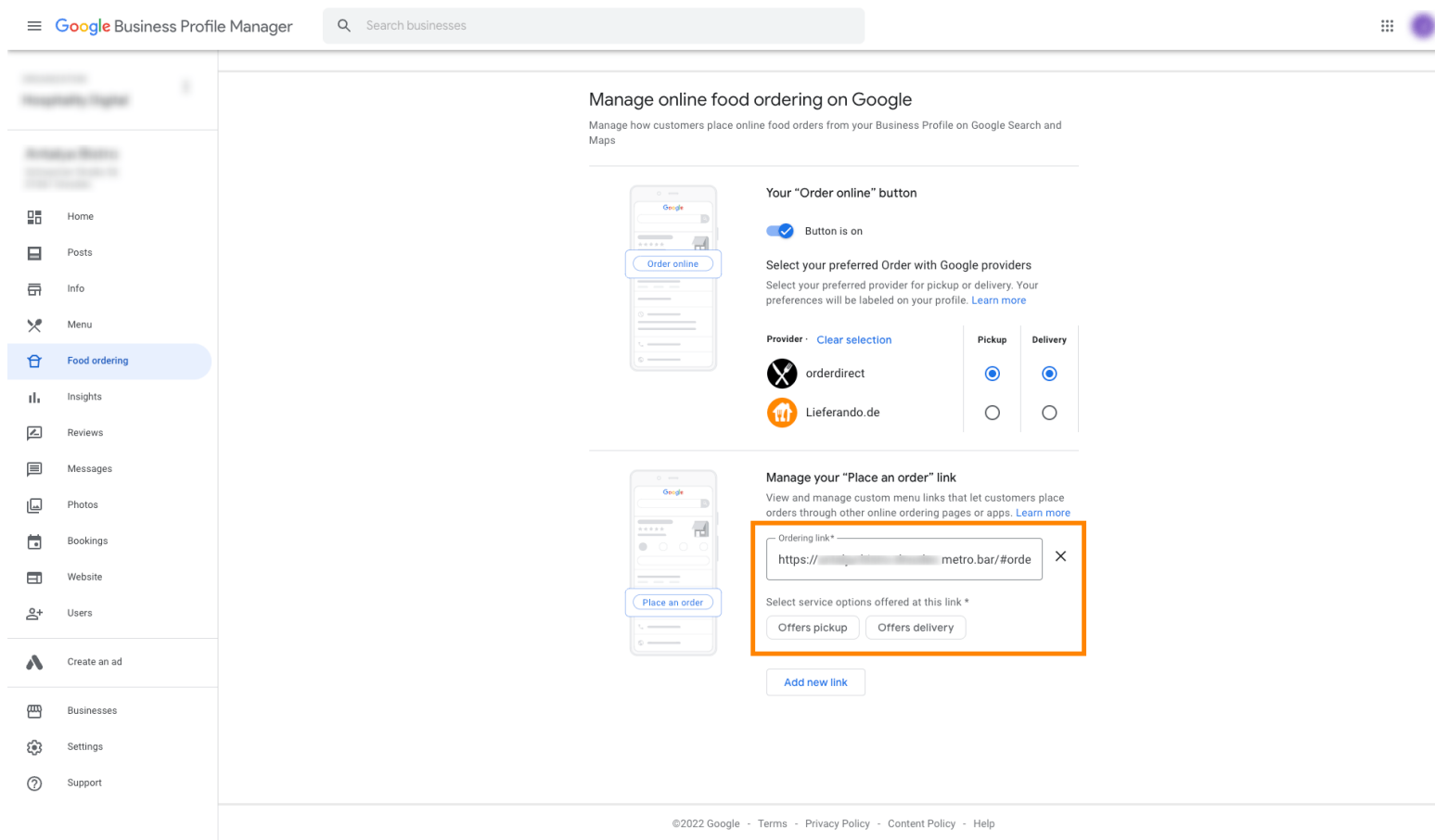

The screenshot shows the Google Business Profile Manager interface. On the left is a sidebar with navigation options: Home, Posts, Info, Menu, Food ordering (highlighted), Insights, Reviews, Messages, Photos, Bookings, Website, Users, Create an ad, Businesses, Settings, and Support. The main content area is titled 'Manage online food ordering on Google' and includes a search bar at the top. Below the title, there's a section for 'Your "Order online" button' with a toggle switch set to 'on'. It then asks to 'Select your preferred Order with Google providers' and lists two providers: orderdirect and Lieferando.de, with radio buttons for 'Pickup' and 'Delivery'. The second section, 'Manage your "Place an order" link', shows a list of links. One link is highlighted with an orange box: 'https://[redacted]metro.bar/#orde'. Below this link, there are buttons for 'Offers pickup' and 'Offers delivery'. At the bottom of the main content area, there is an 'Add new link' button. The footer contains copyright information: '©2022 Google - Terms - Privacy Policy - Content Policy - Help'.



Ora torna al tuo Google Business Profile Manager e assicurati che l'opzione Ordinazione cibo sia **attivata**.

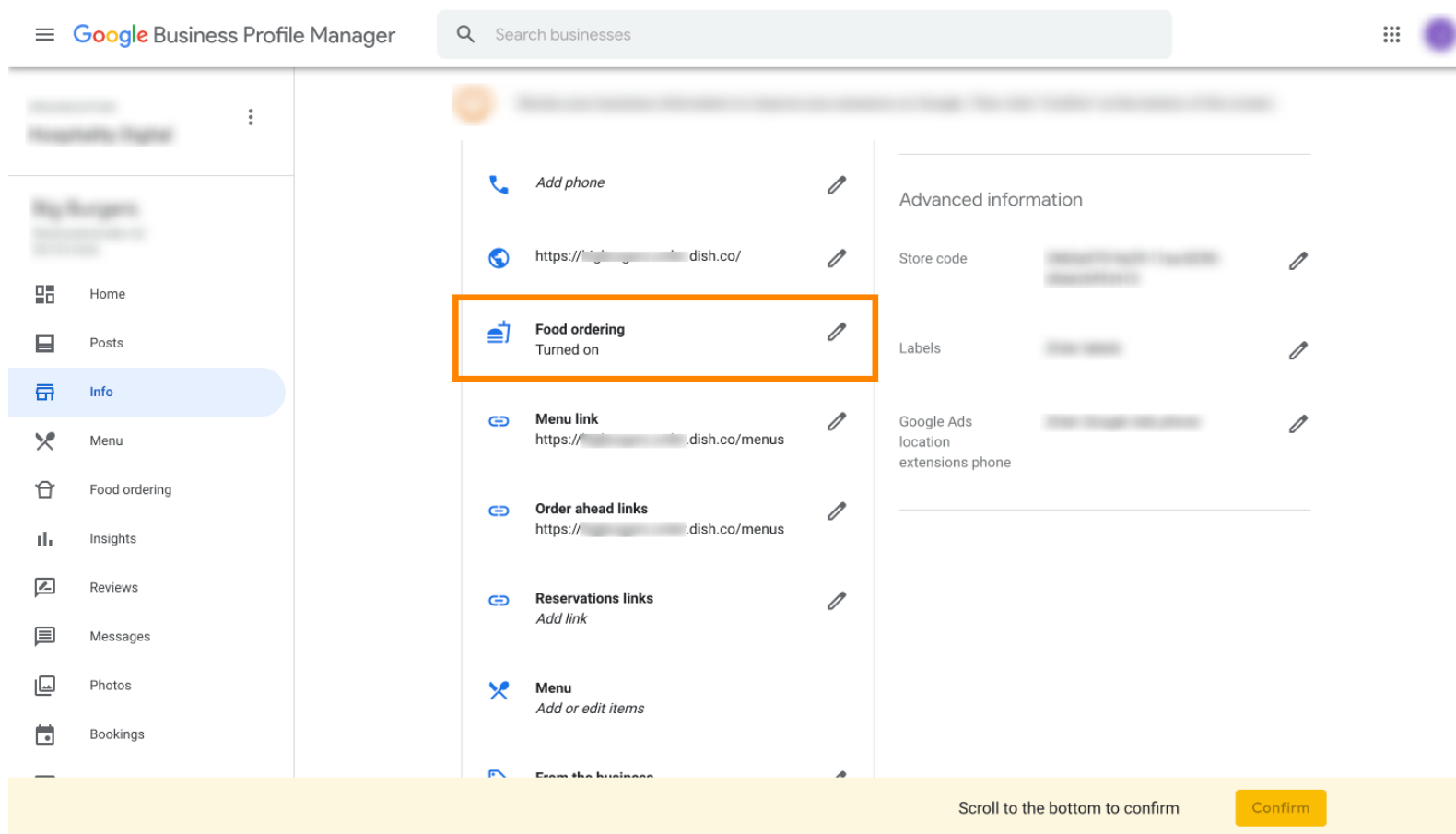



Se hai più partner con cui ordinare cibo, puoi contrassegnare il partner preferito cliccando sull'icona della matita.

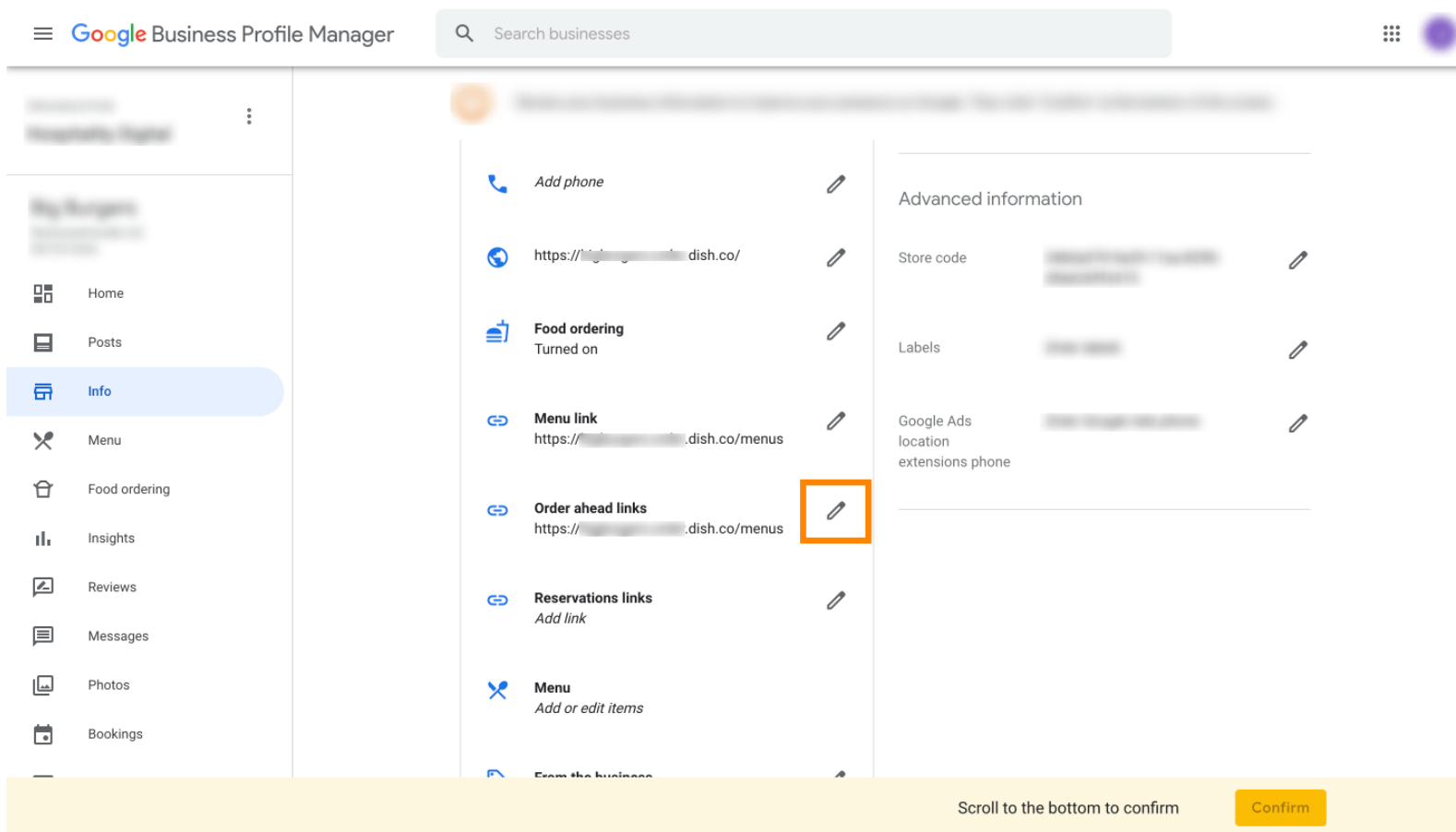

The screenshot shows the Google Business Profile Manager interface. On the left is a sidebar with navigation options: Home, Posts, Info (selected), Menu, Food ordering, Insights, Reviews, Messages, Photos, and Bookings. The main content area is titled 'Google Business Profile Manager' and includes a search bar. Below the search bar, there are several sections for managing business information. The 'Order ahead links' section is highlighted with an orange box, and the edit icon (pencil) next to it is also highlighted with an orange box. The 'Order ahead links' section shows a link to 'https://[redacted].dish.co/menus'. Other sections include 'Add phone', 'Food ordering' (turned on), 'Menu link', 'Reservations links', and 'Menu'. On the right side, there is an 'Advanced information' section with fields for 'Store code', 'Labels', and 'Google Ads location extensions phone', each with an edit icon. At the bottom of the screen, there is a yellow banner with the text 'Scroll to the bottom to confirm' and a 'Confirm' button.



Non è necessario fare clic sull'icona **a forma di stella** per contrassegnare il collegamento preferito come preferito.

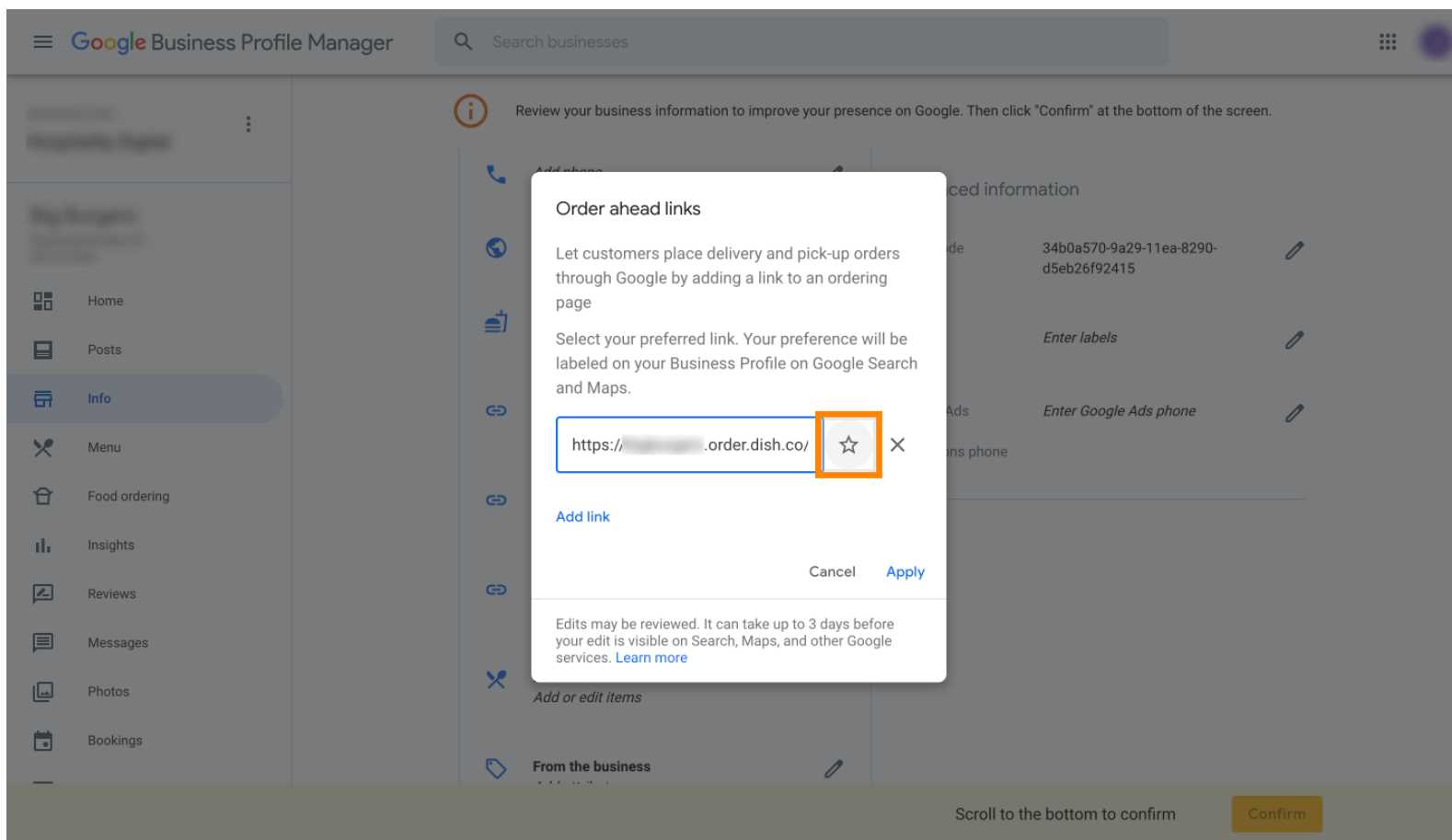

📌 Per sicurezza, seleziona **Applica** . Ecco fatto, hai finito.

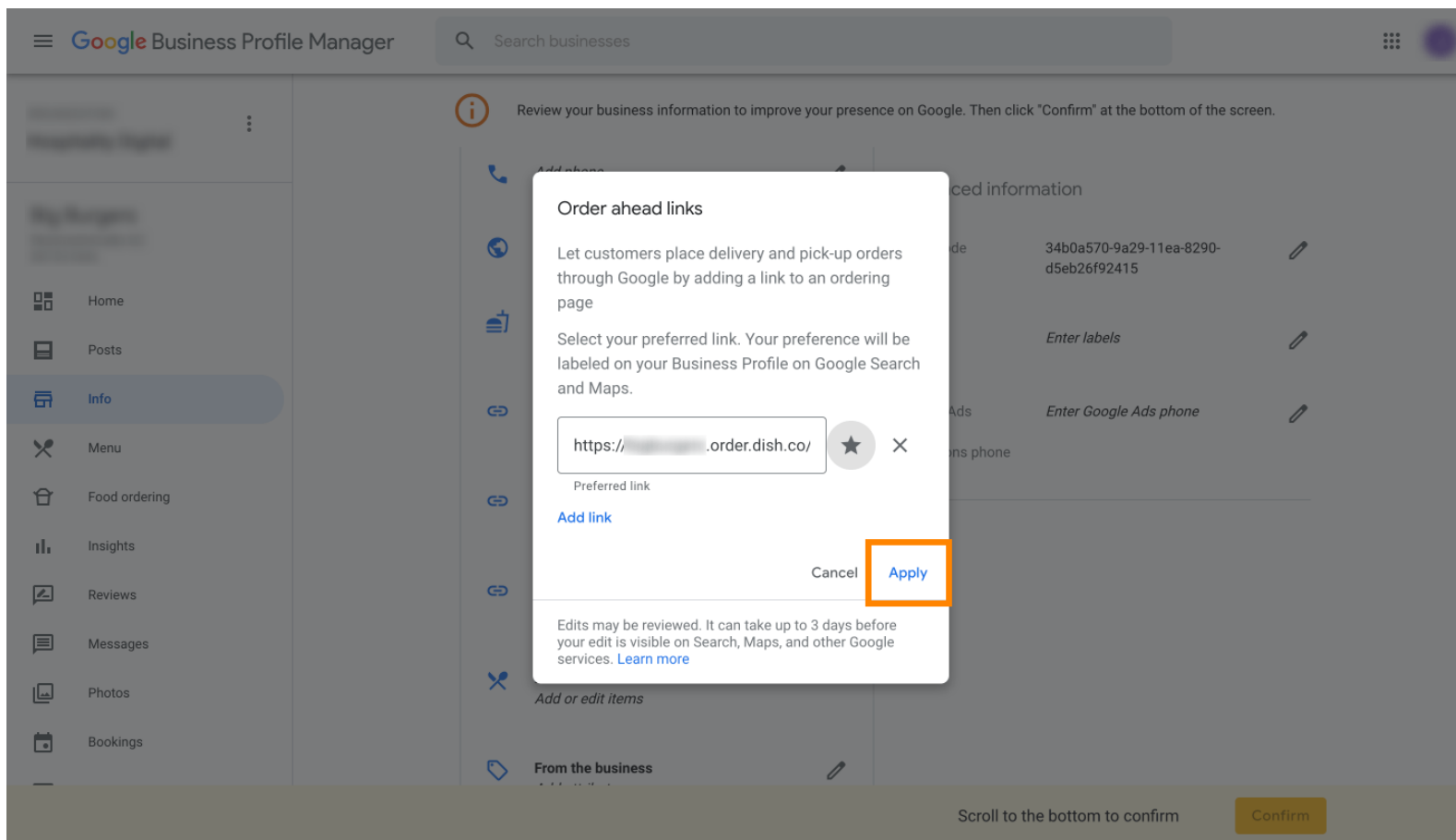



Scansiona per andare al lettore interattivo